

"X" Cartridge
THE CHICAGO® FAUCET COMPANY

1. Loosen cap.
2. Remove unit from body.
3. With handle on STEM, remove STEM NUT. Then turn SLEEVE forcing off SEAT WASHER, SEAT RETAINER and SEAT WASHER.
4. Turn SLEEVE fully on STEM. Replace SEAT if coating is cut or scratched. Replace SEAT WASHER. Use hard SEAT WASHER and blade handle. Now push on SEAT RETAINER and STEM WASHER and complete UNIT by screwing STEM NUT tight.
5. Replace SEAL O-RING. Replace CAP GASKET around top edge of SLEEVE after it has been inserted into body.
6. With UNIT in closed position, place UNIT in body and replace CAP and tighten securely. Add handle. If handle does not continue turning in open position, UNIT is secure.

X

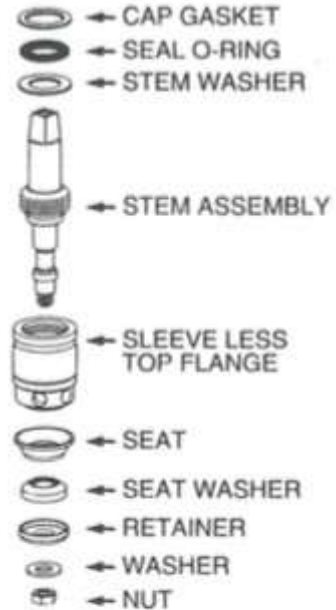

"XT" Cartridge
THE CHICAGO® FAUCET COMPANY

1. Loosen cap.
2. Remove unit from body.
3. With handle on STEM, remove STEM NUT. Then turn SLEEVE forcing off SEAT WASHER, SEAT RETAINER and SEAT WASHER.
4. Replace STEM O-RING.
5. Turn SLEEVE fully on STEM. Replace SEAT if coating is cut or scratched. Replace SEAT WASHER. Use hard SEAT WASHER and blade handle. Now push on SEAT RETAINER and STEM WASHER and complete UNIT by screwing STEM NUT tight.
6. Replace SEAL O-RING. Replace SLEEVE O-RING.
7. With UNIT in closed position, place UNIT in body and replace CAP and tighten securely. Add handle. If handle does not continue turning in open position, UNIT is secure.

XT

